

The easy way to order brake lines

Sample on measuring hose with banjofittings in both ends ex.

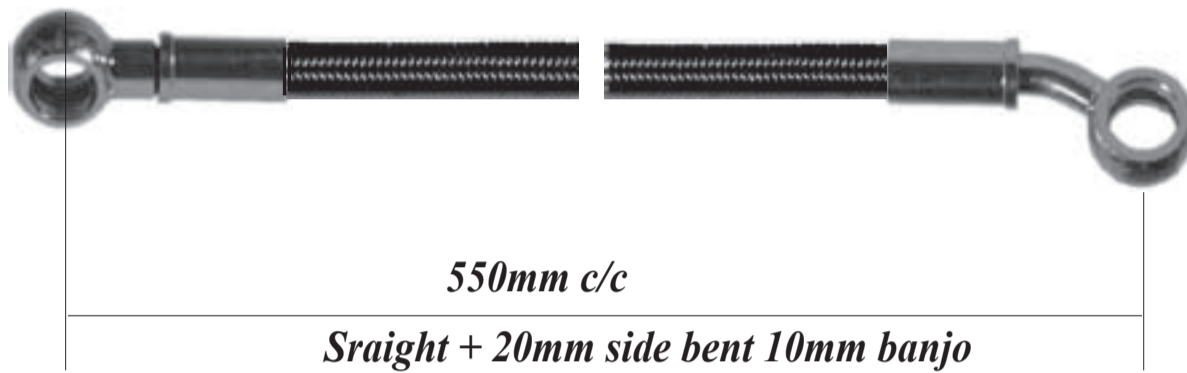

The fittings are adjustable after crimping





Stainless Braided Teflon Hose (is also available in different coloured plastic cover)
Results in a firmer brake pedal. Improved brake pedal "feeling"
and better brake modulation.

Diffusion tight, means no more water in the brake fluid.

Age constant, (rubber gets dry and cracks during time) is compatible with
all brake and clutch fluids.

2807-03

Weight: 65g/m
Measure: id 3,4mm yd 6,3mm
Working Pressure: 320 bar (Burst Pressure 960 bar)
Bend Radius: 38mm
Temp: -60 - +260° C

2807-03CL = Transparent
2807-03BU = Transparent Blue
2807-03CB = Cevlar look Transparent
2807-03RD = Red
2807-03BK = Black
2807-03OR = Orange
2807-03YE = Yellow

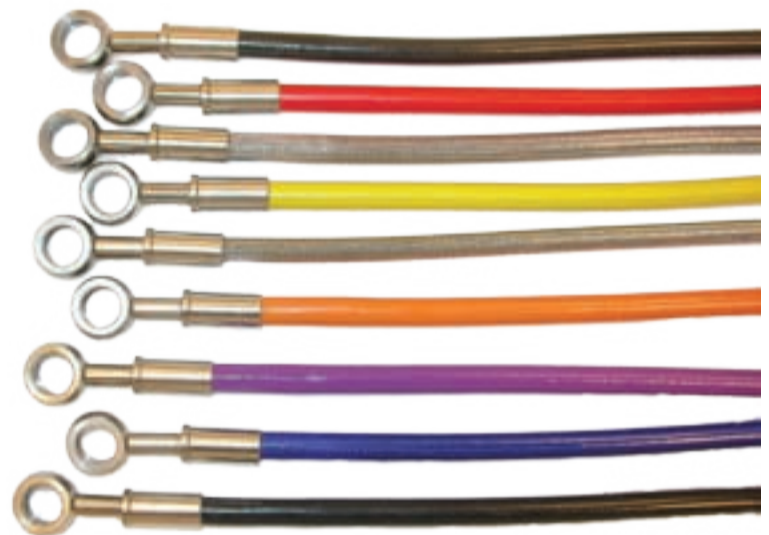

Weight: 78g/m
Measure: id 3,4mm yd 7,6mm
Working Pressure: 320 bar (Burst Pressure 960 bar)
Bend Radius: 38mm
Temp: -60 - +260° C

2807-04

Weight: 70g/m
Measure: id 4,8mm yd 7,6mm
Working Pressure: 205 bar (Burst Pressure 620 bar)
Bend Radius: 51mm
Temp: -60 - +260° C



Please Read :

The Fittings are adjustable after crimping, which means that you can afterwards adjust the angle between two fittings if necessary.

The best way is to mount one fitting and use a tong to turn the ferrule to the correct angle.

To explain the part numbers:

xxxx-xx-xx The four first numbers is for fitting type

Next two numbers is for dimension or size of thread on connection.

ex.

banjo fitting: XXXX-08-XX = 8mm banjo
 XXXX-10-XX = 10mm banjo osv.

mm threaded connection: XXXX-21-XX = M8x1
 XXXX-22-XX = M8x1,25
 XXXX-31-XX = M10x1
 XXXX-32-XX = M10x1,25
 XXXX-35-XX = M10x1,5
 XXXX-41-XX = M12x1
 XXXX-42-XX = M12x1,25
 XXXX-45-XX = M12x1,5
 XXXX-52-XX = M14x1,25
 XXXX-55-XX = M14x1,5

inch threaded connection:	JIC/UNF	NPTF	BSP
	XXXX-02-XX = 5/16-24		
	XXXX-03-XX = 3/8-24	1/8-27	1/8-28
	XXXX-04-XX = 7/16-20	1/4-18	1/4-19
	XXXX-05-XX = 1/2-20		
	XXXX-06-XX = 9/16-18	3/8-18	3/8-19
	XXXX-07-XX = 5/8-18		
	XXXX-08-XX = 3/4-16	1/2-14	1/2-14
	XXXX-10-XX = 7/8-14		5/8-14

The last two numbers is for

Dimension on hose end: XXXX-XX-03 = 1/8
 XXXX-XX-04 = 3/16

Crimp Fittings unf

C = Stainless



Female Swivel

Part no	Thread
6103-03-03	3/8-24 conc
6103-03-03C	3/8-24 conc
6103-04-03	7/16-20 conc
6103-04-03C	7/16-20 conc
6103-04-04	7/16-20 conc



Male Swivel

Part no	Thread
6104-03-03	3/8-24 conc
6104-03-03C	3/8-24 conc
6104-07-03	7/16-24 conc



Male Swivel

Part no	Thread
6105-03-03	3/8-24 conv
6105-03-03C	3/8-24 conv



Female Swivel

Part no	Thread
6117-03-03	3/8-24 conc 45°
6117-03-03C	3/8-24 conc 45°
6117-04-03	7/16-20 conc 45°
6117-04-04	7/16-20 conc 45°
6117-04-04C	7/16-20 conc 45°



Male Swivel

Part no	Thread
6193-03-03	3/8-24 ur conc 45°
6193-03-03C	3/8-24 ur conc 45°



Male Swivel

Part no	Thread
6155-03-03	3/8-24 conv 45°
6155-03-03C	3/8-24 conv 45°



Female Swivel

Part no	Thread
6191-03-03	3/8-24 conc 90°
6191-03-03C	3/8-24 conc 90°
6191-04-03	7/16-20 conc 90°
6191-04-04	7/16-20 conc 90°
6191-04-04C	7/16-20 conc 90°



Male Swivel

Part no	Thread
6194-03-03	3/8-24 conc 90°
6194-03-03C	3/8-24 conc 90°



Male Swivel

Part no	Thread
6195-03-03	3/8-24 conv 90°
6195-03-03C	3/8-24 conv 90°

Crimp Fittings unf

C = Stainless



Male

Part no	Thread
6144-03-03	3/8-24 conv



Male

Part no	Thread
6114-03-03	3/8-24 conc
6114-03-03C	3/8-24 conc



Male

Part no	Thread
6132-04-03	7/16-20 conc/conc



Male

Part no	Thread
6132-04-03L	7/16-20 conc



Female Swivel

Part no	Thread
6141-07-03	7/16-24 conc
6141-07-04	7/16-24 conc
6142-07-03	7/16-24 conv
6142-07-04	7/16-24 conv
6142-17-03	7/16-20 conv



Female Swivel

Part no	Thread
6141-03-03	3/8-24 conc
6141-03-03C	3/8-24 conc
6142-03-03	3/8-24 conv
6142-03-03C	3/8-24 conv



Male

Part no	Thread
6133-04-03	7/16-20 conc



Male

Use Lock nut 924-03

Part no	Thread
6145-03-03	3/8-24 bulkhead conv
6145-03-03C	3/8-24 bulkhead conv



Male / Female

Use Lock nut 2K8686

Part no	Thread
6741-03-03	3/8-24 conc 5/8 male
6741-03-03C	3/8-24 conc 5/8 male
6742-03-03	3/8-24 conv 5/8 male



Female

Part no	Thread
6150-03-03	3/8-24 conv

Crimp Fittings mm

C = Stainless



Female

Part no	Thread
6101-31-03	M10 x 1 conc
6101-31-03C	M10 x 1 conc



Female Swivel

Part no	Thread
6103-31-03	M10 x 1 conc
6321-31-03	M10 x 1 conv



Male Swivel

Part no	Thread
6104-31-03	M10 x 1 conc
6104-31-03C	M10 x 1 conc
6104-32-03	M10 x 1,25 conc
6104-32-03C	M10 x 1,25 conc



Male Swivel

Part no	Thread
6105-31-03	M10 x 1 conv
6105-31-03C	M10 x 1 conv
6105-32-03	M10 x 1,25 conv
6105-32-03C	M10 x 1,25 conv



Male

Part no	Thread
6123-31-03	M10 x 1 conc
6123-31-03C	M10 x 1 conc
6123-32-03	M10 x 1,25 conc
6123-32-03C	M10 x 1,25 conc



Female Swivel

Part no	Thread
6141-31-03	M10 x 1 conc
6141-31-03C	M10 x 1 conc
6141-32-03	M10 x 1,25 conv
6141-32-03C	M10 x 1,25 conv
6142-31-03	M10 x 1 conv
6142-31-03C	M10 x 1 conv
6142-32-03	M10 x 1,25 conv
6142-32-03C	M10 x 1,25 conv

Crimp Fittings mm

C = Stainless



Female Swivel

Part no	Thread
6141-31-03RC	M10 x 1 conc
6142-31-03RC	M10 x 1 conv



Female Swivel

Part no	Thread
6141-31-03T	M10 x 1 conc
6142-31-03T	M10 x 1 conv

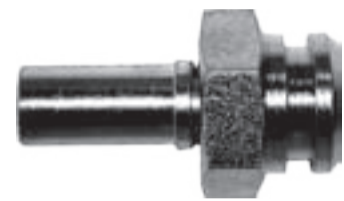

Female Swivel

Part no	Thread
6141-31-03Z	M10 x 1 conc
6142-31-03Z	M10 x 1 conv



Male

Part no	Thread
6144-31-03	M10 x 1 conv
6144-31-03C	M10 x 1 conv
6144-32-03	M10 x 1,25 conv
6144-32-03C	M10 x 1,25 conv



Male

Part no	Thread
6132-41-03	M12 x 1 conc/conv



Female Swivel

Part no	Thread
6141-41-03	M12 x 1 conc
6141-41-04	M12 x 1 conc
6142-41-03	M12 x 1 conv
6142-41-04	M12 x 1 conv

Crimp Fittings mm

C = Stainless



Female Swivel



Male Swivel



Male Swivel

Part no	Thread
6117-31-03	M10 x 1 conc 45°

Part no	Thread
6154-31-03	M10 x 1 conc 45°
6154-31-03C	M10 x 1 conc 45°
6154-32-03	M10 x 1,25 conc 45°

Part no	Thread
6155-31-03	M10 x 1 conv 45°
6155-31-03C	M10 x 1 conv 45°
6155-32-03	M10 x 1,25 conv 45°
6155-32-03C	M10 x 1,25 conv 45°



Female Swivel



Male Swivel



Male Swivel

Part no	Thread
6191-31-03	M10 x 1 conc 90°

Part no	Thread
6194-31-03	M10 x 1 conc 90°
6194-31-03C	M10 x 1 conc 90°
6194-32-03	M10 x 1,25 conc 90°
6194-32-03C	M10 x 1,25 conc 90°

Part no	Thread
6195-31-03	M10 x 1 conv 90°
6195-31-03C	M10 x 1 conv 90°
6195-32-03	M10 x 1,25 conv 90°
6195-32-03C	M10 x 1,25 conv 90°

Crimp Fittings mm

C = Stainless



Female Swivel

Part no	Thread
6141-31-03A	M10 x 1 conc AUDI



Female Swivel

Part no	Thread
6141-31-03P	M10 x 1 conc Porsche



Male

Part no	Thread
6144-31-03L	M10 x 1 conv/conc BMW



Female

Part no	Thread
6150-31-03VR	M10 x 1 conc Viper



Female Swivel

Part no	Thread
6743-31-03	M10 x 1 conv Toyota



Female Swivel

Part no	Thread
6744-31-03	M10 x 1 conv Toyota



Female Swivel

Part no	Thread
6745-31-03	M10 x 1 conv Subaru



Female Swivel

Part no	Thread
6746-31-03	M10 x 1 conc Audi TT

Crimp Fittings mm

C = Stainless



Male

Part no	Thread
6144-31-03EXT	M10 x 1 conv extended



Male

Use Lock Nut 318-31

Part no	Thread
6145-31-03	M10 x 1 conc bulkhead
6145-31-03C	M10 x 1 conc bulkhead



Male

Use Lock Nut 318-31

Part no	Thread
6143-31-03	M10 x 1 conv bulkhead
6143-31-03C	M10 x 1 conv bulkhead
6143-41-04	M12 x 1 conv bulkhead



Female

Use Lock Nut 2K8686

Part no	Thread
6741-31-03	M10 x 1 conc 5/8 male
6741-31-03C	M10 x 1 conc 5/8 male
6742-31-03	M10 x 1 conv 5/8 male
6742-31-03C	M10 x 1 conv 5/8 male



Female Swivel

Part no	Thread
6129-45-03	M12 x 1,5 spherical seat
6129-55-03	M14 x 1,5 spherical seat

Crimp Fittings mm

C = Stainless



Part no	Dia ø
6192-08-03	Banjo 8mm
6192-10-03	Banjo 10mm
6192-10-03C	Banjo 10mm
6192-11-03	Banjo 11mm
6192-11-03C	Banjo 11mm
6192-12-03	Banjo 12mm
6192-10-04	Banjo 10mm

Part no	Dia ø
6192-10-03ML	Banjo 10mm med.long
6192-10-03MLC	Banjo 10mm med.long
6192-10-03L	Banjo 10mm long
6192-10-03LC	Banjo 10mm long
6192-11-03ML	Banjo 11mm med.long
6192-11-03MLC	Banjo 11mm med.long
6192-10-04ML	Banjo 10mm med.long
6192-11-04L	Banjo 10mm long

Part no	Dia ø
6193-10-03	Banjo 10mm 20°
6193-10-03C	Banjo 10mm 20°
6193-11-03	Banjo 11mm 20°
6193-11-03C	Banjo 11mm 20°
6196-10-03	Banjo 10mm 35°
6196-10-03C	Banjo 10mm 35°
6194-10-03	Banjo 10mm 45°
6194-10-03C	Banjo 10mm 45°
6170-10-03	Banjo 10mm 70°
6170-10-03C	Banjo 10mm 70°
6193-10-04	Banjo 10mm 20°
6194-10-04	Banjo 10mm 45°
6170-10-04	Banjo 10mm 70°



Part no	Dia ø
6197-10-03	Banjo 10mm 20° side
6197-10-03C	Banjo 10mm 20° side
6297-10-03	Banjo 10mm 75° side
6297-10-03C	Banjo 10mm 75° side
6299-10-03	Banjo 10mm 90° side
6299-10-03C	Banjo 10mm 90° side

Part no	Dia ø
6199-10-03	Banjo 10mm 90°
6199-10-03C	Banjo 10mm 90°
6199-11-03	Banjo 11mm 90°
6199-11-03C	Banjo 11mm 90°
6199-10-04	Banjo 10mm 90°



Part no	Dia ø
6193-10-03B	Banjo 10mm 15° Block

Part no	Dia ø
6198-10-03	Banjo 10mm Double
6198-10-03C	Banjo 10mm Double

Crimp Fittings bsp

C = Stainless



Female Swivel

Part no	Thread
6321-03-03	1/8 bsp conv
6321-03-03C	1/8 bsp conv



Female Swivel

Part no	Thread
6331-03-03	1/8 bsp conv 45°



Female Swivel

Part no	Thread
6332-03-03	1/8 bsp conv 90°

Minimess



Female Swivel

Part no	Thread
6101-04-03	1/4 bsp Flat seal

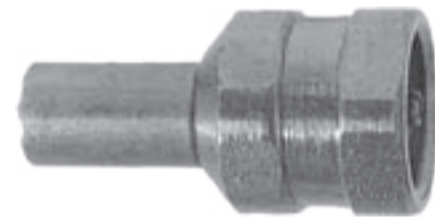

Female Swivel

Part no	Thread
6101-62-03	M16 x 2 minimess

Crimp Fittings NPT



Male Swivel

Part no	Thread
6102-03-03	1/8 NPT

Adapters

C = Stainless



Part no	Thread
816-03	3/8-24 x 1/8 npt
816-03C	3/8-24 x 1/8 npt

Part no	Thread
823-03	3/8-24 x 1/8 npt 45°
823-03C	3/8-24 x 1/8 npt 45°

Part no	Thread
822-03	3/8-24 x 1/8npt 90°
822-03C	3/8-24 x 1/8npt 90°



Part no	Thread
825-03	3/8-24 x 1/8 npt T
825-03C	3/8-24 x 1/8 npt T

Part no	Thread
826-03	3/8-24 x 1/8 npt T



Part no	Thread
763-03-03	3/8-24 unf conv x 1/8 npt
763-03-04	7/16-20 unf conv x 1/8 npt

Part no	Thread
835-03	1/8 npt x 3/8-24 if conv
835-04	7/16-24 if x 1/8 NPT
835-05	1/2-20 if x 1/8 NPT
835-06	5/8-18 if x 1/4 NPT
835-07	3/4-18 if x 3/8 NPT

Part no	Thread
836-03	1/8 npt x 3/8-24 conv 90°

Adapters

C = Stainless



Part no	Thread
837-03	3/8-24 unf conv bulkhead 45°

Part no	Thread
833-03	3/8-24 unf conv bulkhead 90°
833-03C	3/8-24 unf conv bulkhead 90°



Part no	Thread
832-03	3/8-24 unf conv bulkhead
832-03C	3/8-24 unf conv bulkhead
307-03-31	M10 x 1 conv bulkhead

Part no	Thread
804-03	3/8-24 unf conv bulkhead
804-03C	3/8-24 unf conv bulkhead



Part no	Thread
924-03	3/8-24 Lock Nut
924-03C	3/8-24 Lock Nut
2K8686	5/8 W Lock Nut
318-31	M10 x 1 Lock Nut

Part no	Thread
834-03	3/8-24 unf conv bulkhead
834-03C	3/8-24 unf conv bulkhead

Adapters

C = Stainless



Part no	Thread
815-03	3/8-24 Equal
815-03C	3/8-24 Equal

Part no	Thread
9821-03	3/8-24 Equal 90°

Part no	Thread
824-03	3/8-24 T
824-03C	3/8-24 T



Part no	Thread
305-03-21	3/8-24 unf conv x M8 x 1 conv
305-03-21C	3/8-24 unf conv x M8 x 1 conv
305-03-31	3/8-24 unf conv x M10 x 1 conv
305-03-31C	3/8-24 unf conv x M10 x 1 conv
305-03-32	3/8-24 unf conv x M10 x 1,25 conv
305-03-41	3/8-24 unf conv x M12 x 1 conv
305-03-41C	3/8-24 unf conv x M12 x 1 conv
305-03-42	3/8-24 unf conv x M12 x 1,25 conv
305-03-45	3/8-24 unf conv x M12 x 1,5 conv
305-03-45C	3/8-24 unf conv x M12 x 1,5 conv
305-04-31	7/16-20 unf conv x M10 x 1 conv
305-04-41	7/16-20 unf conv x M12 x 1 conv

Part no	Thread
306-03-21	3/8-24 unf conv x M8 x 1 conc
306-03-31	3/8-24 unf conv x M10 x 1 conc
306-03-32	3/8-24 unf conv x M10 x 1,25 conc
306-03-35	3/8-24 unf conv x M10 x 1,5 conc
306-03-41	3/8-24 unf conv x M12 x 1 conc
306-03-45	3/8-24 unf conv x M12 x 1,5 conc
306-03-55	3/8-24 unf conv x M14 x 1,5 conc
306-03-08	3/8-24 unf conv x M18 x 1,5 conc



Part no	Thread
707-03-04	3/8-24 unf conv x 7/16-20 conc
707-03-05	3/8-24 unf conv x 1/2-20 conc
707-03-06	3/8-24 unf conv x 9/16-18 conc
707-03-07	3/8-24 unf conv x 7/16-24 conc
815-03V	3/8-24 unf conv x 3/8-24 conc
815-03VL	3/8-24 unf conv x 3/8-24 conc long

Part no	Thread
742-03-31	M10 x 1 conc x R 1/8 bsp conc
742-03-32	M10 x 1,25 conc x R 1/8 bsp conc
741-03-03V	3/8-24 conc x R 1/8 bsp conc

Adapters

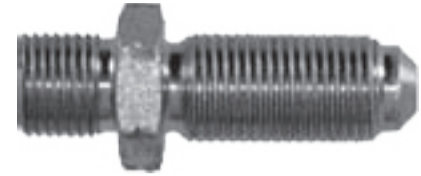
Part no	Thread
945-03-31	R 1/8 bsp conc x M10 x 1 conv
945-03-32	R 1/8 bsp conc x M10 x 1,25 conv
741-03-03	R 1/8 bsp conc x 3/8-24 conv

Part no	Thread
946-03-31	R 1/8 bsp conc x M10 x 1 conv
743-03-03	R 1/8 bsp conc x 3/8-24 conv



Part no	Thread
972052	3/8-24 conv

Part no	Thread
918-01	1/8 npt if 4 way

Part no	Thread
220-303	3/8-24 if conc
320-041	M12 x 1 conv

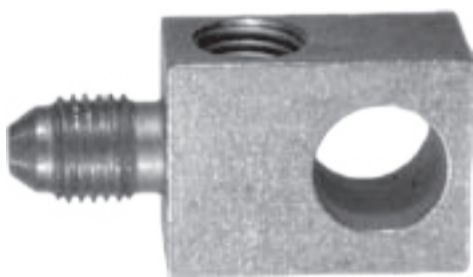

Part no	Thread
G105A	3/8-24 conv

Part no	Thread
220-403	3/8-24 conc 4 way

Part no	Thread
319-031	M10 x 1 conc

Banjo Bolts

C = Stainless



Part no	Thread
992-03-21	M8 x 1 banjo bolt
992-03-31	M10 x 1 banjo bolt
992-03-31C	M10 x 1 banjo bolt
992-03-32	M10 x 1,25 banjo bolt
992-03-32C	M10 x 1,25 banjo bolt
992-03-35	M10 x 1,5 banjo bolt
992-03-35C	M10 x 1,5 banjo bolt
992-04M121	M12 x 1 banjo bolt
992-04-42	M12 x 1,25 banjo bolt
992-04-45	M12 x 1,5 banjo bolt
992-06-55	M14 x 1,5 banjo bolt
992-06-65	M16 x 1,5 banjo bolt



Part no	Thread
775-03	3/8-24 banjo bolt
775-03C	3/8-24 banjo bolt
775-04	7/16-20 banjo bolt
775-04C	7/16-20 banjo bolt
775-06	9/16-18 banjo bolt
977-522	7/16-24 banjo bolt
1012-03	R1/8 banjo bolt



Part no	Thread
993-03-21	M8 x 1 banjo bolt double
993-03-31	M10 x 1 banjo bolt double
993-03-31C	M10 x 1 banjo bolt double
993-03-32	M10 x 1,25 banjo bolt double
993-03-32C	M10 x 1,25 banjo bolt double
993-04-45	M12 x 1,5 banjo bolt double
993-06-55	M14 x 1,5 banjo bolt double
993-06-65	M16 x 1,5 banjo bolt double



Part no	Thread
773-03	3/8-24 banjo bolt double
773-03C	3/8-24 banjo bolt double
1013-03	R1/8 banjo bolt double



Part no	Thread
BK992-03-31	M10 x 1 brake light switch
BK992-03-32	M10 x 1,25 brake light switch
BK992-03-03	3/8-24 unf brake light switch



Part no	Thread
BK993-03-31	M10 x 1 brake light switch double
BK993-03-32	M10 x 1,25 brake light switch double

Accessories

C = Stainless



Part no	Dia ø
776-03	3/8-24 x 10mm banjo
776-03-04	3/8-24 x 11mm banjo



Part no	Dia ø
779-03	3/8-24 x 10mm banjo



Part no	Thread
314-031	M10 x 1 Plugg



Part no	Thread
932-02	1/8 NPT Plugg Insex

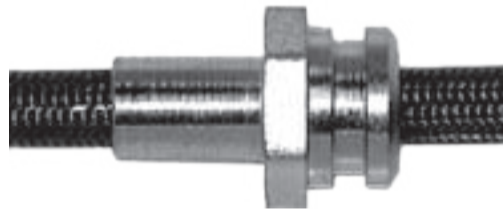

Part no	Line Locator
BLT1	Line Locator



Part no	Line Locator
BLT2	Line Locator



Part no	Line Locator
BLT3	Line Locator



Part no	Line Locator
BLT4	Line Locator



Part no	Line Locator
BLT301NY	Line Locator

Accessories

C = Stainless



Part no	
BLT302NY	Line Locator

Part no	Dia ø
819-03	3/16 Tube Sleeve
819-03C	3/16 Tube Sleeve
819-04	1/4 Tube Sleeve
819-04C	1/4 Tube Sleeve

Part no	Dia ø
6100-00-03	Crimp Ferruel 1/8" Crimp Dim 8,0mm
6100-00-03C	Crimp Ferruel 1/8" Crimp Dim 8,0mm



Part no	Dia ø
6100-00-04	Crimp Ferruel 3/16" Crimp Dim 9,5mm
6100-00-04C	Crimp Ferruel 1/8" Crimp Dim 9,5mm

Part no	Thread
818-03	3/8-24 Nut
818-03C	3/8-24 Nut
818-04	7/16-20 Nut
818-04C	7/16-20 Nut

Part no	Dia ø
445-16	10mm Copper Crush Washers
445-18	11mm Copper Crush Washers
445-19	12mm Copper Crush Washers



Brake / Fuel Stainless Steel Tubing

Part no	Dia ø
6100-00-00	1/8 Whip Guard

Part no	Dim.
SS316	3/16
SS014	1/4
SS038	3/8